

Detached, DIP switch

HF-1060

1. 5.8GHz microwave motion sensor with dimmable function.
2. Suitable for Tri-Proof light.
3. Detached version flexible installation.
4. Constant current output.
5. 3 year limited warranty.

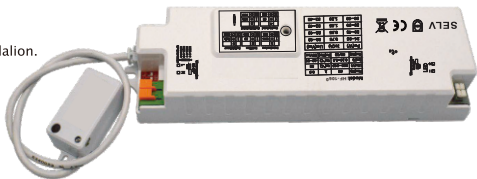

On/off control



Detection area



Hold time



Daylight threshold



Stand-by period



Stand-by dimming level



Optional Current



warranty
3
years

Detection coverage

This figure indicates the maximum distance at the highest mounting height with 100% sensitivity.

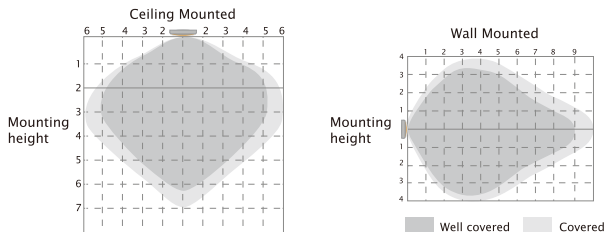

Technical data

Input voltage	220~240VAC 50/60Hz
Input current	0.29A(Max)
Input power	24~65W (Max)
Stand-by power	≤1W(230VAC)
Output LED current	750mA/900mA/1000mA/1200mA ±5%
Output LED voltage	≤60V(Empty Load),Load Voltage DC48V(32~50V)
Output LED power	25W~65W
Detection area	50%/100%
Hold time	5s/30s
Daylight threshold	30Lux/Disable
Stand-by period	0s/30s
Stand-by dimming level	10%/30%
Microwave frequency	5.8GHz±75MHz
Microwave power	<0.3mW
Mounting height	3~6m (ceiling mounted)
HF Detection range	Detection surface diameter 8-12m
Empty load voltage	≤55VDC
Power factor	≥0.9
Efficiency	≥82% (Max.)
Operating temperature	Ta: -20°C~50°C Tc: 80°C
Abnormal protection	SCP: Auto recovery,OVP,OCP,OTP
IP rating	IP20

Mechanical structure

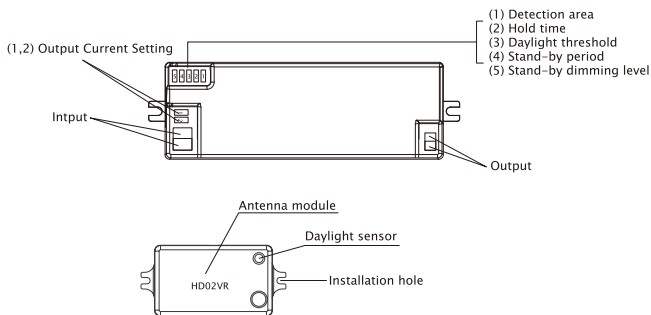

Dimensions (Unit: mm)

HT175-304T Wire diameter 3mm, Standard Version Cable Length 330 ± 10 mm (can be customized).

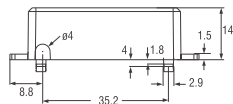
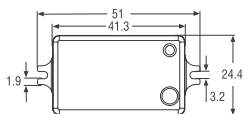
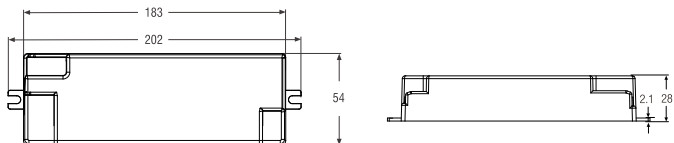

HD02VR

Wiring diagram

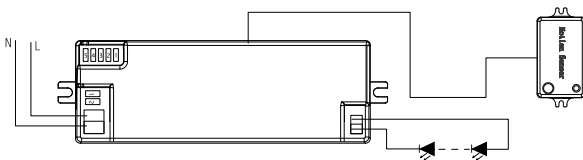

Settings



Switch UP

Switch DOWN

Stand-by dimming level

Stand-by period

Daylight threshold

Hold-time

Detection area



Output Current Setting

<input checked="" type="checkbox"/>	<input checked="" type="checkbox"/>	1200mA
<input type="checkbox"/>	<input checked="" type="checkbox"/>	1000mA
<input checked="" type="checkbox"/>	<input type="checkbox"/>	900mA
<input type="checkbox"/>	<input type="checkbox"/>	750mA

<input checked="" type="checkbox"/>	100%
<input type="checkbox"/>	50%

Detection area

In this area, movement will be detected and able to trigger the sensor. 100% detection area is also known as the strong sensitivity.

<input checked="" type="checkbox"/>	5s
<input type="checkbox"/>	30s

Hold-time

The period of light keeping 100% brightness after moving objects leave the detection area.

<input checked="" type="checkbox"/>	Disable
<input type="checkbox"/>	30lux

Daylight threshold

Definition of the ambient brightness; only when the ambient brightness is lower than the preset specific lux amount, the sensor will work; when it's preset as "disable", the sensor works everytime it detects motion regardless the ambient brightness.

<input checked="" type="checkbox"/>	0s
<input type="checkbox"/>	30s

Stand-by period

The period of light keeping low output before it's completely switched off. When it's preset as " ∞ ", the light always keep at low output if no movement in the detection area and doesn't turn off.

<input checked="" type="checkbox"/>	10%
<input type="checkbox"/>	30%

Stand-by dimming level

The definition of low output in the standby period.

Installation Method

4 styles of installation

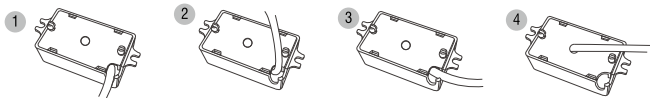

Cable on center

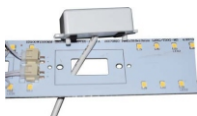
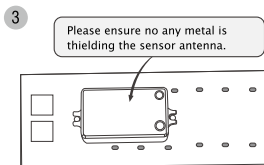
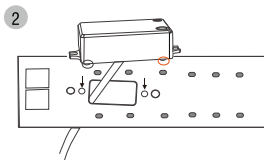
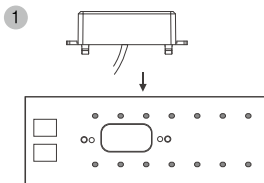

Cable on tip side

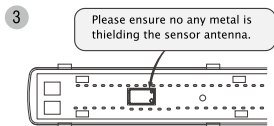
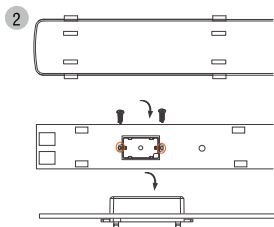
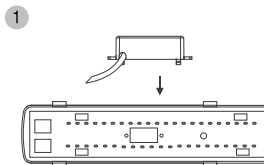

Application

1. Automatically ON/OFF function:

Light on when detect movement and off after people leave at night. Applications: Corridor, Staircase.
The daylight threshold is set to "30lux"



With sufficient daylight, even when motion detected, light remains OFF.



With insufficient daylight, when motion detected, light ON.

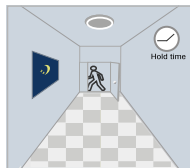

After the last detection and the present hold time elapsed, light OFF.

2. No daylight function

The daylight threshold is set to "Disable".

Light on when detect movement, After people leave, Light off after stand-by period.

Applications: Dim places such as Basement Parking, Underpass.



When motion is detected, the sensor will switch on the light to 100% brightness.

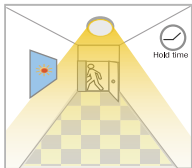

After people leave the detection area, light remains 100% brightness within hold time.

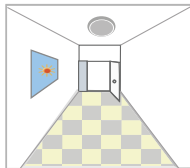

After the last detection and the present hold time elapsed, light OFF.

3. Function Demo - Dimmable control/Corridor function



With sufficient daylight, even when motion detected, light remains OFF.



With insufficient daylight, when motion detected, light ON.



After last detection, the light will be dimmed down to the stand-by dimming level (10% or 30%) after holdtime.

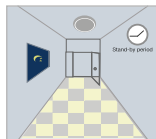

After the stand-by period, light OFF.

Attention



1. Please read the instructions carefully before using this product and keep it well for all users to read at any time.
2. The sensor should be installed by qualified electrician and ensure power is off before the installation.
3. We reserve the right to modify any incorrect text, image and necessary technical parameters.
4. Any unauthorized modification is forbidden, otherwise all guarantees will be immediately invalid.

Installation precautions

1. Microwave sensor can be installed in any lamp except the one with full metal shell.
2. The detected surface cannot be shielded by metal objects.
3. Make sure the microwave module is completely exposed outside.
4. The detection surface of the sensor module shall be installed facing the detection area.
5. Should be kept away from the driver to avoid interference generation and lamp flashing.
6. Wiring must be strictly in accordance with the wiring diagram to avoid short circuit.

Application Environment

1. Suitable for indoor installation to avoid false triggering due to external factors such as rain, wind or tree swing.
2. Shall not be installed in the place with all four metal shelters and small space (such as galvanized-iron roof).
3. Shall note be mounted installation, so as to avoid false trigger caused by the lamp itself shaking.
4. Shall not be installed next to large operating machines such as ventilator/ceiling fan to avoid false triggering caused by machine vibration.

User Notes

1. Microwave can penetrate walls or glass thinner than 20cm and attenuate if thicker than 20cm.
2. The driver voltage shall be stable and float within 10%.
3. Detection area will be affected by speed of motion, mounting height and movement volume.
4. Conduct test on sunny days without the lampshade which will affect the tested lux value.